

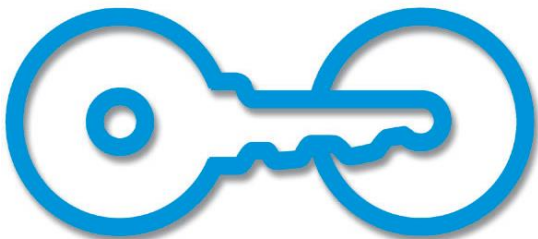

# Fixit® Plus



The Fixit Plus includes all the tools necessary to perform basic bike repairs and maintenance, from changing a flat to adjusting brakes and derailleurs. Stainless steel cables and tamper-proof fasteners securely attach tools to the stand, while the hanging arms allow pedals and wheels to spin freely while making adjustments. Add a second hanger for double sided access to the tools!



**American Bicycle Security Company**

P.O. Box 7359

Ventura, CA 93006

Ph: (800) 245-3723 or (805) 933-3688

Fax: (805) 933-1865

[www.ameribike.com](http://www.ameribike.com)

Email: [turtle@ameribike.com](mailto:turtle@ameribike.com)

# Fixit® Plus

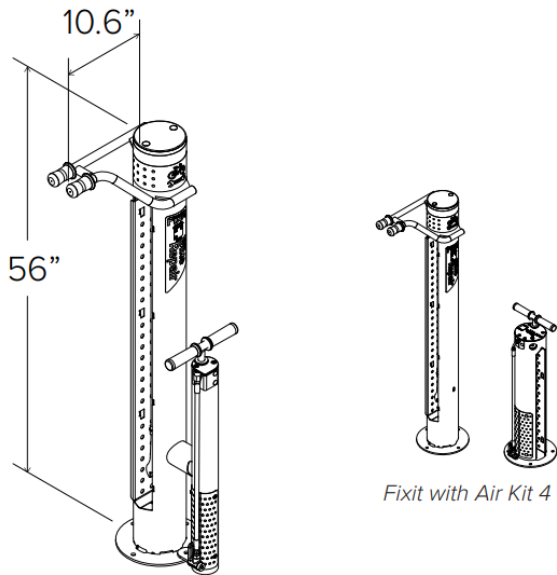

Fixit with Air Kit 4

**Product** Fixit® Plus  
**Capacity** 1 Bike – Not a lockable device  
**Materials** Main body: 6" x 12g tube  
 Bike Hanger: 1" solid round bar  
 Foot: 10" dia. x .25" plate  
 Tool tethers: 3/16" stainless steel cable  
 Manual air pump

**Hand tools:**

- Philips and flat head screwdrivers
- 2.5, 3, 4, 5, 6, 8mm Allen wrenches
- T25 Torx wrench
- 32mm Headset wrench
- 15mm Pedal wrench
- 8, 9, 10, 11mm box wrenches
- Tire levers (2)

**Finishes** Standard options: Galvanized



RAL 9005	Flat Black	RAL 9003	RAL 2004	RAL 1023	Bright Yellow
RAL 6016	RAL 6018	RAL 6005	RAL 3003	RAL 3005	Purple
RAL 7011	RAL 7042	RAL 9007	RAL 1001	RAL 8014	Bronze

**Installation Methods** **Foot Mount** has 10" diameter x.25" foot with four anchors per foot. Tamper-resistant fasteners are included.

**Optional Features** **Second Hanger** For double sided access

**Wheel Catch** Available to hold bikes with no kick stands

**Cane Stop** (Come in galvanized only)

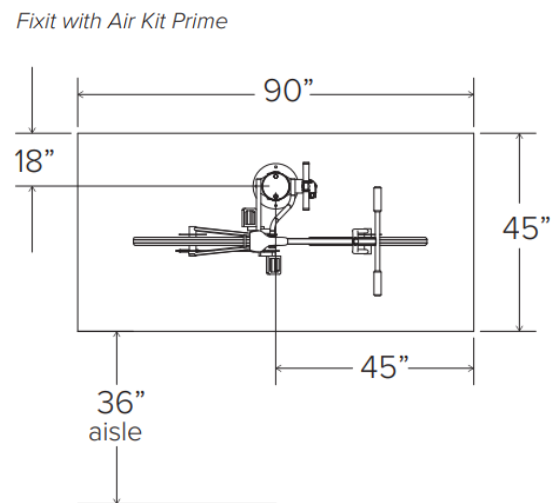

Minimum Footprint

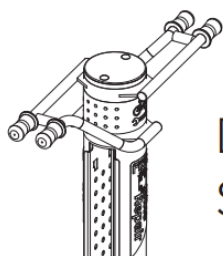

Double Sided

An optional wheel catch is available to hold bikes with no kick stands

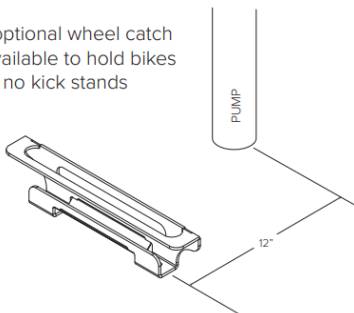

A cane-detectable attachment beneath the hanger arms is available for improved safety. (Additional cost)

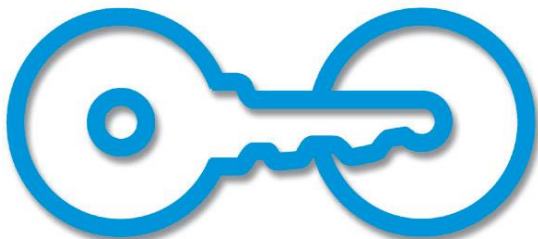
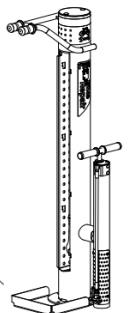

**American Bicycle Security Company**

P.O. Box 7359  
 Ventura, CA 93006  
 Ph: (800) 245-3723 or (805) 933-3688

Fax: (805) 933-1865

[www.ameribike.com](http://www.ameribike.com)

Email: [turtle@ameribike.com](mailto:turtle@ameribike.com)

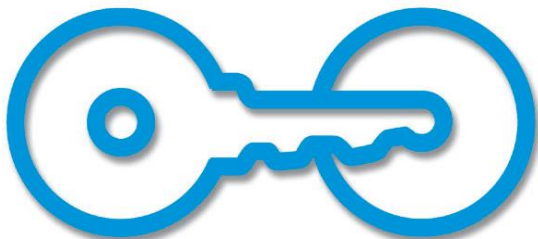
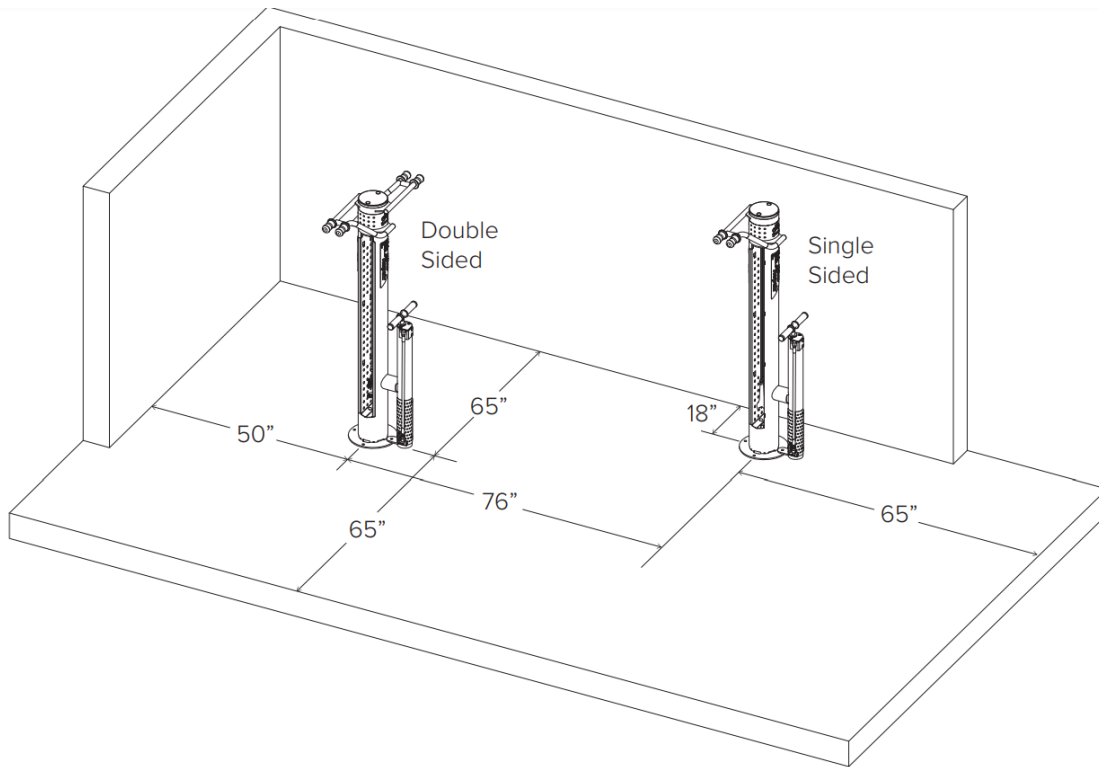



### Tools Needed for Installation

- Hammer drill
- 3/8" masonry bit
- Hammer
- Socket Wrench
- 9/16", 3/4" socket
- Tamper-proof socket (included)
- Socket extension, 6" min.
- Razor Blade

### Recommended Base Materials:

Solid concrete is the best base material for installation. To ensure the proper anchors are shipped with your rack, ask your representative which anchor is appropriate for your application. Be sure nothing is underneath the base material that could be damaged by drilling.



**Be sure to save your tamper-resistant tools for any future maintenance. They are costly to replace.**

**If you are not attaching an Air kit Prime to your Fixit, proceed to set 4**

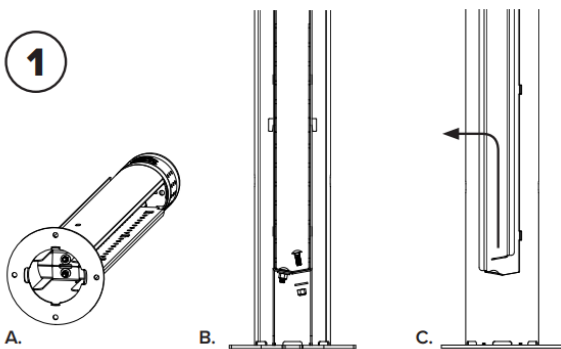

- (A) Lay the Fixit Plus on its side.  
 (B) Remove one 3/8" carriage bolt, lock nut, and washer.  
 (C) The guard can then be pushed up and then pulled out. Set the guard aside.

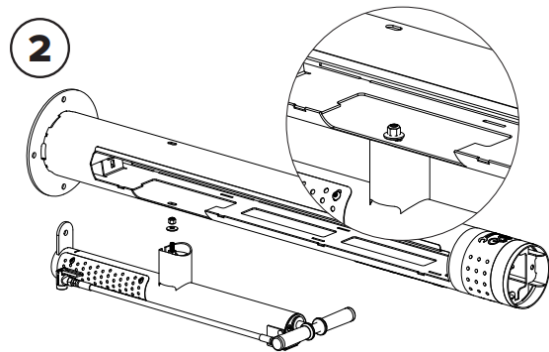

Secure the Air Kit to the side of the Fixit Plus with the 3/8" threaded stud on the Air Kit and a bonded washer and lock nut inside the Fixit Plus.

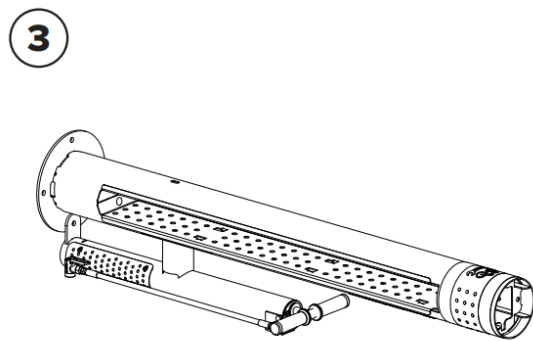

Reattach the guard

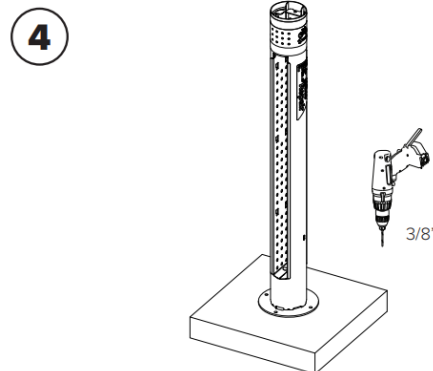

Reference the Fixit Plus setback recommendations and place the upright in the desired location. Use the base as a template to mark anchor locations and drill (4) 3/8" x 3" holes in the concrete with a hammer drill and masonry bit. Clean up all concrete dust from drilling.



**If installing the optional cane stop, See Page 6.**

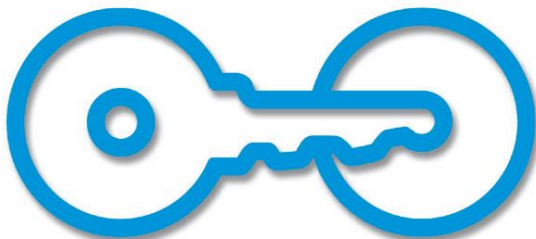



5

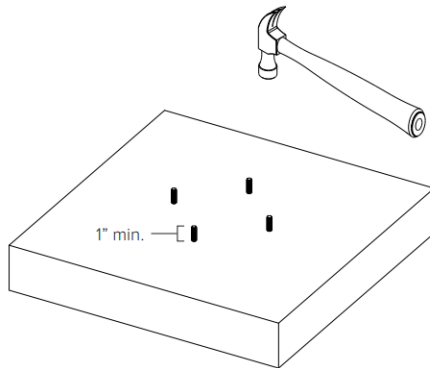

Hammer in the (4) 3/8" wedge anchors. Leave at least 1" of exposed threads above the concrete.

6

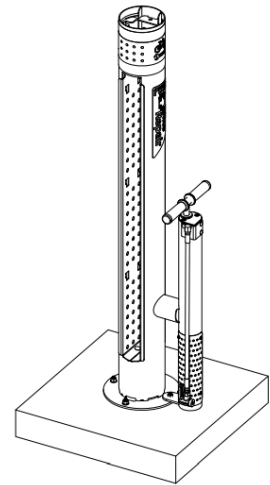

Place the Fixit Plus over the anchors, add washers and nuts, and tighten all nuts.

7

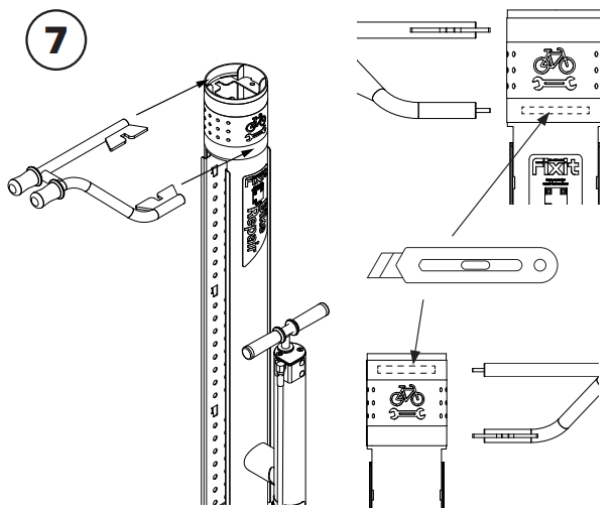

Select the orientation of the bike hanger and use a new razor blade to cut through the decal to reveal the corresponding slot in the Fixit Plus.

8

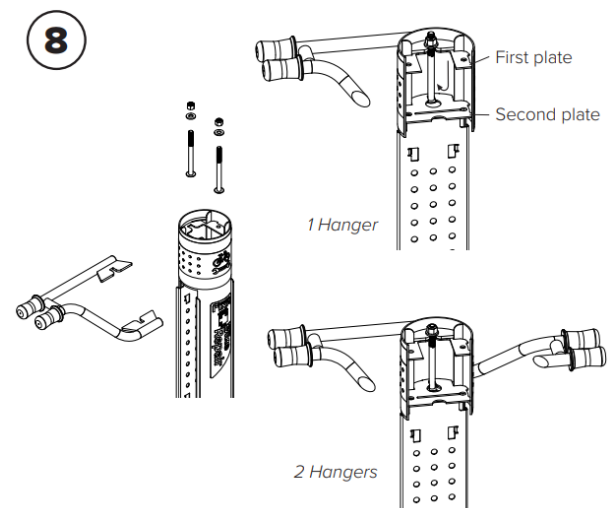

Add the 1/2" washer and 1/2" lock nut to the 1/2" x 6" carriage bolt. Insert the assembled hardware, headfirst, into the top of the Fixit Plus. The carriage bolt head will pass through the second plate hole and then slide sideways, so the carriage bolt engages the slot in both plates and bike hanger. Tighten the lock nut and repeat with the other side. If two bike hangers are used, the carriage bolt will also engage the second bike hanger under the second plate.

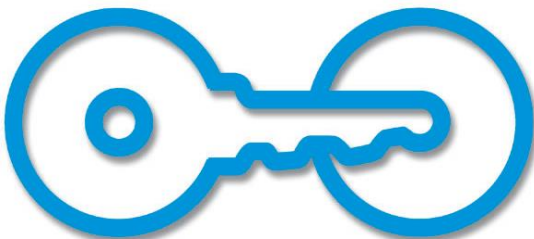

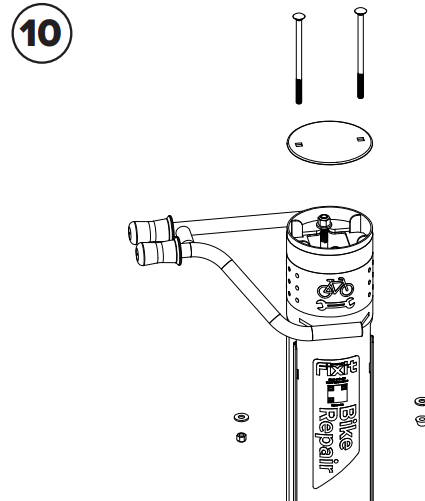
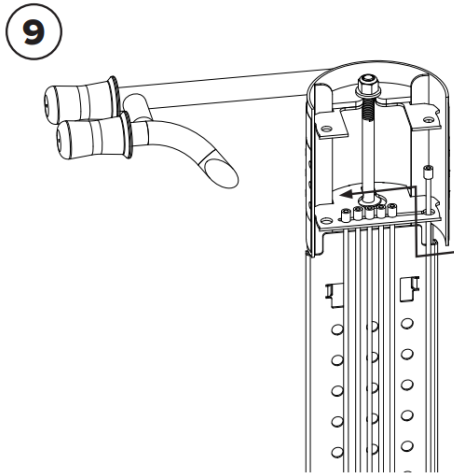

Place the top cap on the Fixit Plus and insert the (2) 3/8" x 7" carriage bolts through the top cap, first plate, and second plate of the Fixit Plus. Secure the carriage bolts with washers and nuts. The Penta nut goes over the hole the tool cables were inserted into.

### Concrete Foundation Recommendations

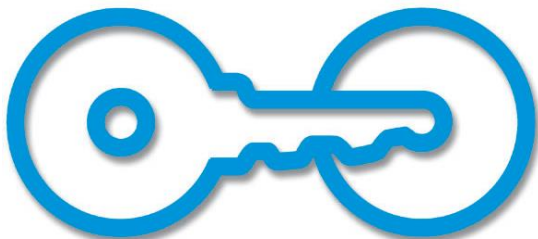
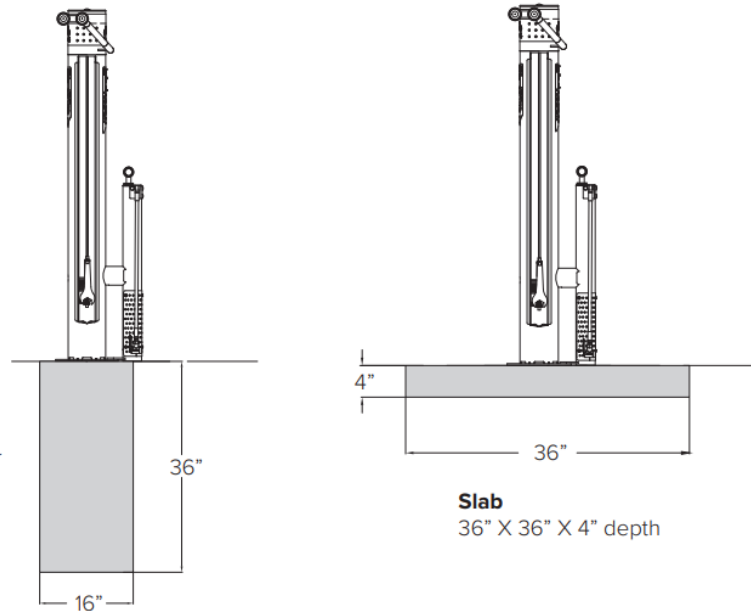

**American Bicycle Security Company**

P.O. Box 7359

Ventura, CA 93006

Ph: (800) 245-3723 or (805) 933-3688

Fax: (805) 933-1865

[www.ameribike.com](http://www.ameribike.com)

Email: [turtle@ameribike.com](mailto:turtle@ameribike.com)



See diagrams below for guidance on installing the optional Cane Stop. This attachment provides a cane-detectable barrier beneath the hanger arms of the Fixit for improved safety

3/8" wedge anchors  
included with  
standard Fixit Plus

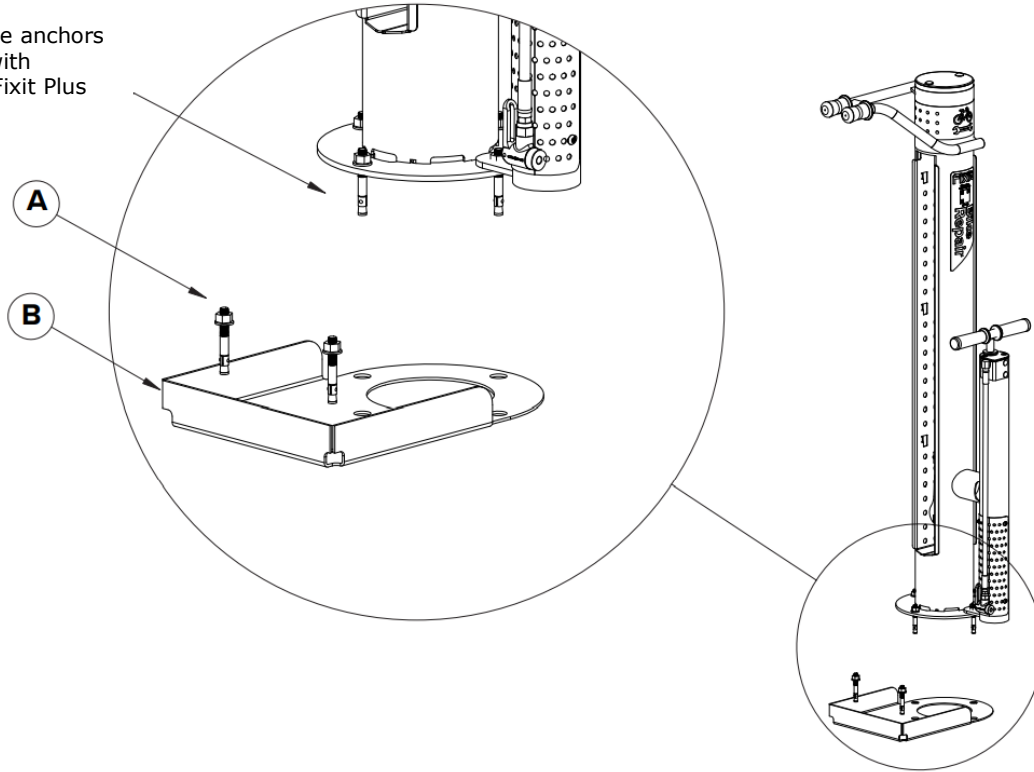

**A** 3/8" x 3" Wedge Anchors

x2



**B** Cane Stop

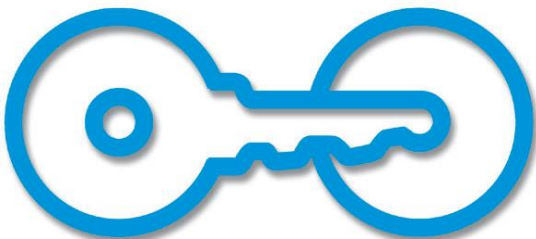



All threads for all parts of the pump are right-hand threads. They tighten clockwise, and loosen counter-clockwise ("righty tighty, lefty loosey"). However, when you are looking top-down at a bolt that threads from underneath, if you move it counter-clockwise from your point of view, you are actually tightening, not loosening, the nut! This has led to some unnecessary breakage of pump parts. Be sure you are looking at the nut with the proper orientation before tightening or loosening.

### REMOVING THE AIR KIT FROM THE FIXIT PLUS

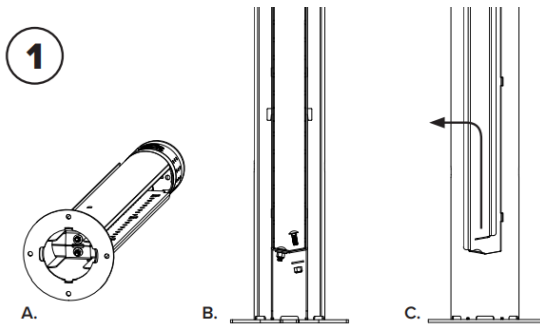

- (A) Lay the Fixit Plus on its side.
- (B) Remove one 3/8" carriage bolt, lock nut, and washer.
- (C) The guard can then be pushed up and then pulled out. Set the guard aside.

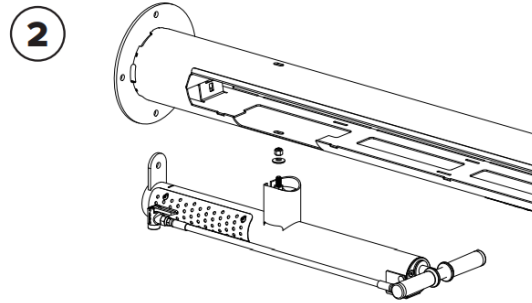

Remove nut attaching the Air Kit to the side of the Fixit Plus.

### REMOVING THE AIR KIT FROM THE FIXIT PLUS

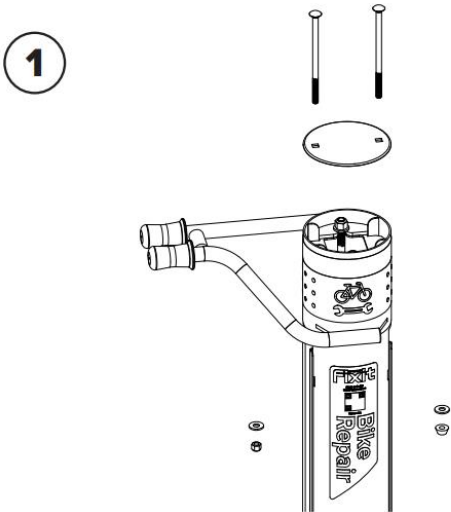

Remove the 3/8" nut and penta tamper-proof nut from the underside of the top compartment and lift out the carriage bolts. These are all best removed with a socket wrench, using the extension tool to enable you to reach the nuts.

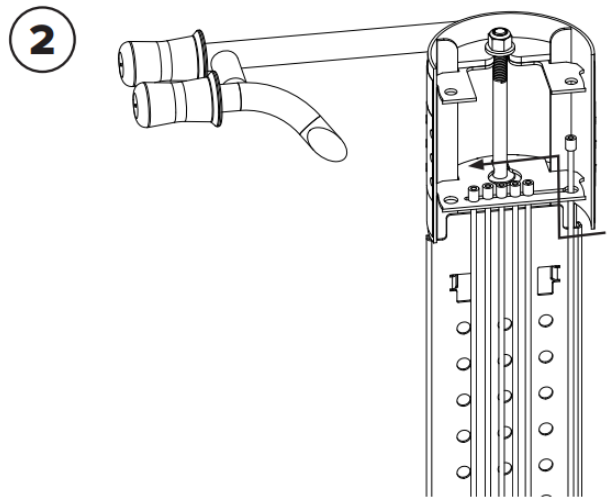

Add or remove tools by sliding the tool cables through the hole at the end of the cable slot in the Fixit Plus upright.

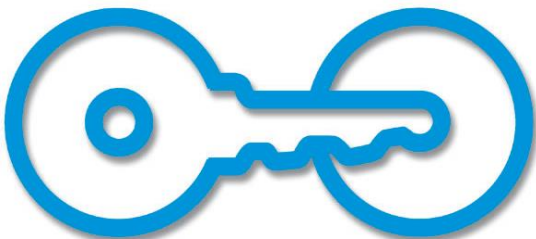

**American Bicycle Security Company**

P.O. Box 7359

Ventura, CA 93006

Ph: (800) 245-3723 or (805) 933-3688

Fax: (805) 933-1865

[www.ameribike.com](http://www.ameribike.com)

Email: [turtle@ameribike.com](mailto:turtle@ameribike.com)