

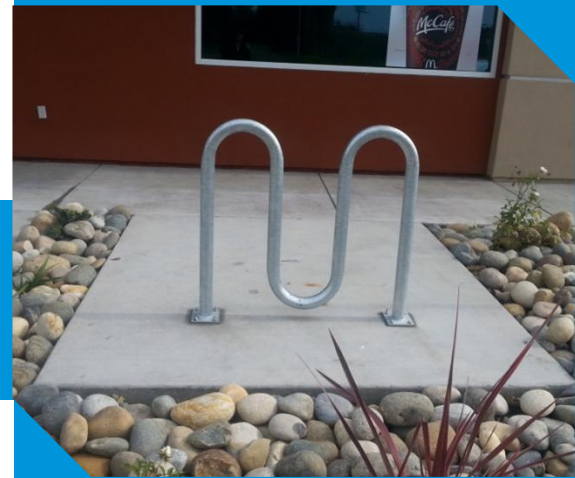

Rolling Rack Mini



The Rolling Rack Mini is especially suited for locations where short-term, medium security bike parking is needed. It is an inexpensive, space efficient option that is popular with shops and convenience stores.

The Rolling Rack Mini can be installed into a concrete base or can be ordered freestanding. It comes in a three loop or two loop model.

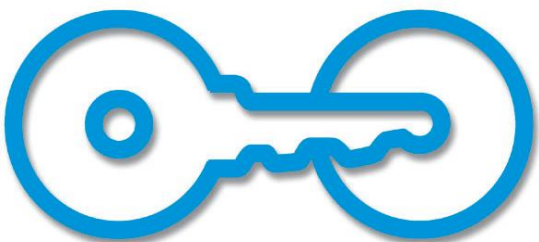

American Bicycle Security Company

P.O. Box 7359

Ventura, CA 93006

Ph: (800) 245-3723 or (805) 933-3688

Fax: (805) 933-1865

www.ameribike.com

Email: turtle@ameribike.com

Rolling Rack Mini

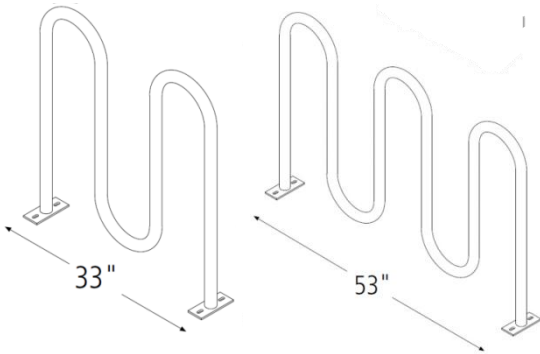

Product Rolling Rack

Capacity RRM2H: 4 Bikes
RRM3H: 6 Bikes

Materials 1.66" OD Schedule 40 pipe

Finishes An after fabrication hot dipped galvanized finish is our standard option.



Installation Methods Foot Mount has two 2.5"x6"x.25" feet with two anchors per foot. Specify foot mount for this option.

Space Use & Setbacks

Wall Setbacks:

For racks set perpendicular to a wall:

Minimum: 24"
Recommended: 36"

Street Setbacks:

Parallel to street: 96"
Perpendicular to street: 24"
Recommended: 36"

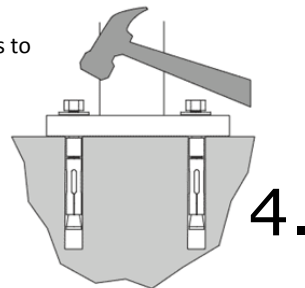
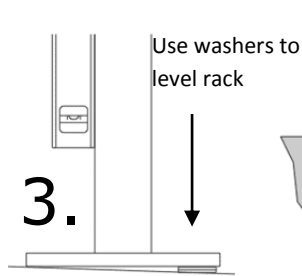
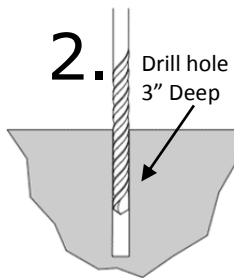
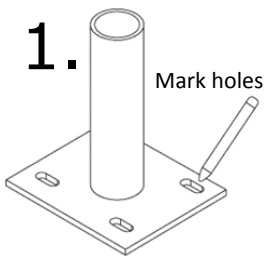
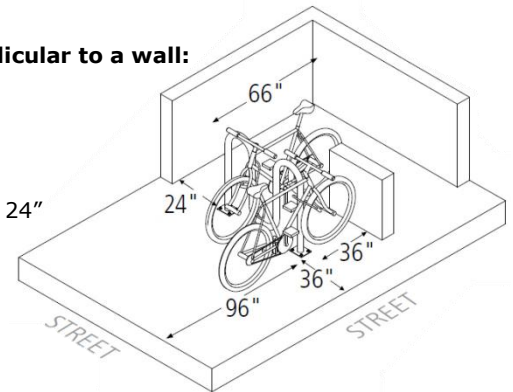

(Anchors will vary according to install surface)

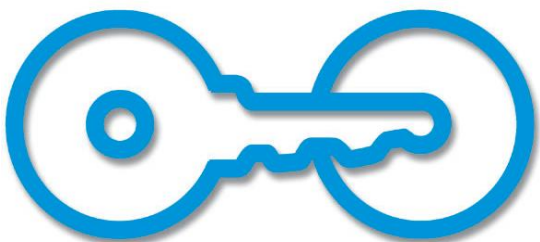

American Bicycle Security Company

P.O. Box 7359

Ventura, CA 93006

Ph: (800) 245-3723 or (805) 933-3688

Fax: (805) 933-1865

www.ameribike.com

Email: turtle@ameribike.com